

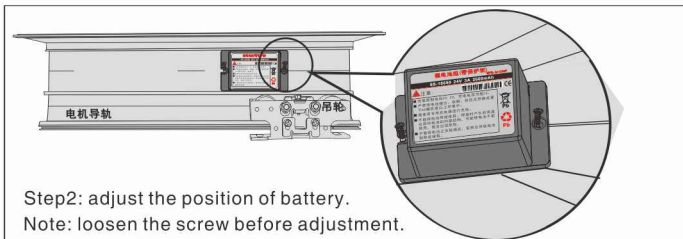

YLI ELECTRONIC

# Automatic door back-up power with lithium battery

Model: YAD-150PS



Step2: adjust the position of battery.  
Note: loosen the screw before adjustment.

Step3: The connection between battery and main controller.

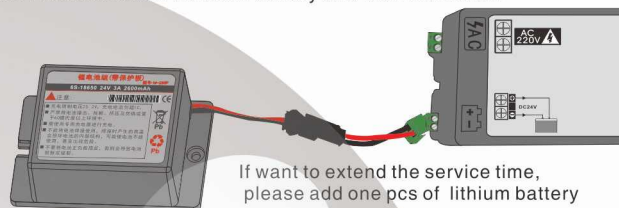

If want to extend the service time, please add one pcs of lithium battery

## 1 Safety Instruction

Thanks so much for purchasing this product, please read this instruction before using.

## 2 Product overview

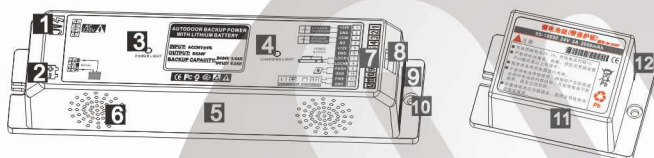

- |                                  |                     |                                      |
|----------------------------------|---------------------|--------------------------------------|
| 1 220V Power Input               | 5 Main Controller   | 9 Access line connector              |
| 2 lithium battery connector      | 6 louver *4pcs      | 10 Installation hole *2pcs           |
| 3 Power light                    | 7 Controller Wiring | 11 lithium battery                   |
| 4 lithium battery charging light | 8 discharge switch  | 12 lithium battery wiring connection |

## 3 Overall Characteristic

- Specially designed for automatic door back-up power. The power can help automatic door work normally once power off (open-close about 500 times, around 7hours) or keep door open automatically based on fire evacuation requirements.
- Battery charge-discharge management by micro-computer. Have setting of quick charge, trickle charge and cut off the power automatically in low tension. The life time of battery is long.

When lithium battery is working, blue light flicks

- integrate with access power function, available for access control to connect with automatic door.

## 4 Installation and Adjustment

Note:

1.If want to extend the service time, please add one pcs of lithium battery when power failure happened.

2.Please put the battery into track in 30°incline

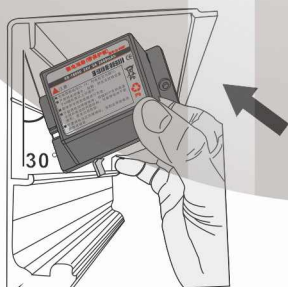

Step1 Put the battery pack into guide rail, slipping to suitable position and fix by special screws.

## 5 Wiring

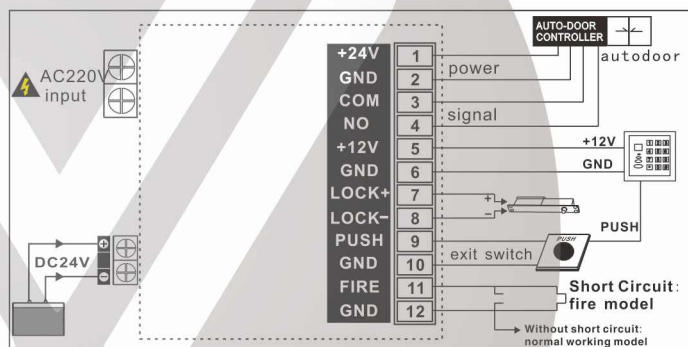

## 6 Function setting

- Working mode: Normal working mode or fire model
- BACKUP TO NORMAL
- ▶ Working mode: FIRE and GND (NO short circuit)
    - Door work as normal once power failure.
  - ▶ Fire mode: FIRE and GND short circuit
    - Door keep open once power failure.
- EMERGENCY OPEN

## 7 Note

- 2 kinds of wires of AC input: Live line and Zero line.
- Please connect two storage batteries in series to get DC24V.
- Please charge storage batteries up to 12hours before first using.
- Maintenance should be under taken by professional maintainer.
- System will automatically be cut when the storage batteries low to certain voltage rated value

## 8 Parameter

Input Voltage:	AC220V, 50Hz
Output Voltage:	DC24V, 2.6AH; DC12V, 5.2AH
Working Mode:	Automatic working or keep opening
Indicator and Protect	Charging proceeding shown by LED. Low voltage will automatically cut.
charging time:	Around 10 hours
Open times:	About 550 times
Controller Dimension:	243 (L) × 59 (W) × 45 (H) mm
storage battery size:	96 (L) × 43 (W) × 55 (H) mm