



YLI ELECTRONIC

# Exit button with dual function of infrared sensing and push

Model: ISK-845(LED)

## Overview

This is a dual-function (infrared sensing + mechanical pressing) with all active target area access control exit button .  
When the infrared sensing fails, it can be operated manually to exit.

## Specification

- Dimension: 86Lx86Wx15.5H(mm)
- Voltage: 12~24VDC
- Current:  $\leq 60\text{mA}$
- Output: Infrared Sensor: NO/NC/COM  
Push to exit: NO/COM
- Contact Rating: Infrared Sensor: 1A 24VDC  
Push to exit: 12VDC 50mA
- Sensor Range: 5 ~ 12cm adjustable
- Operating Temperature:  $-20 \sim +50^{\circ}\text{C}$
- LED Indicator: Red LED standby status,  
Green LED: unlocking status
- Material: Faceplate: PC surface sprayed with  
oil and UV treatment  
Backbox: ABS high gloss finish
- Weight: 0.2kg
- Product advantages: anti-fouling, wear-resistant,  
impact-resistant and UV-resistant

## Installation & Size

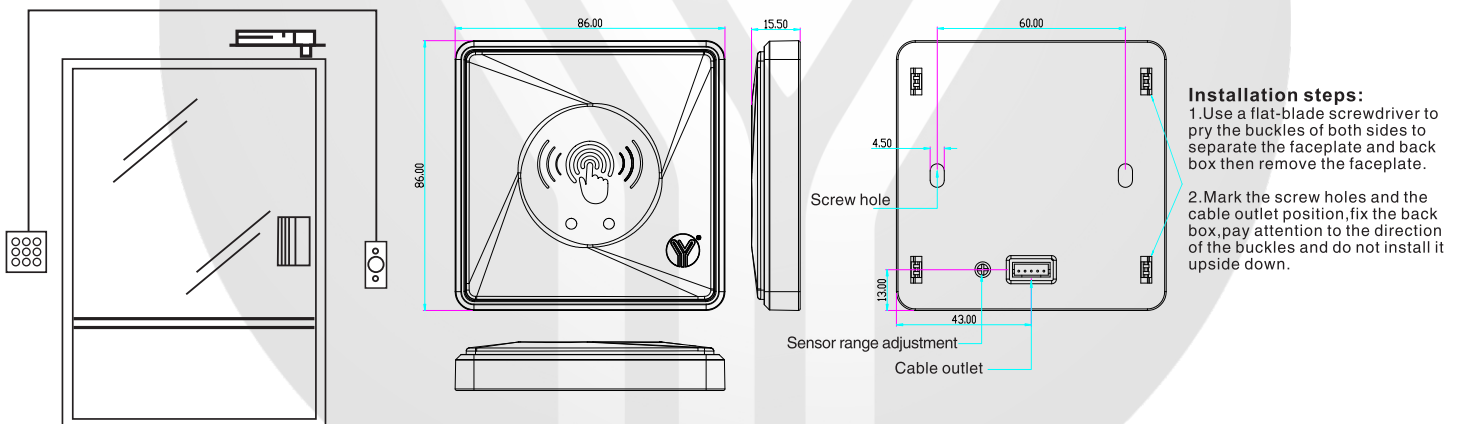

## Wiring Diagram

### Wiring of infrared sensing

Clockwise rotation induction  
distance becomes shorter  
Anticlockwise rotation induction  
distance becomes longer

Induction distance adjustable



Red  + Yellow  NC  
Black  - White  COM  
Green  NO

### Push to exit wiring

White  COM  
Green  NO