



YLI ELECTRONIC

# Mortise Mount Magnetic Lock



## Specification

Model	YM-180M(SS304)	YM-180M-S(SS304)
Dimension	196Lx35Wx20.5H(mm)	196Lx35Wx20.5H(mm)
Armature plate	130Lx32Wx10H(mm)	130Lx32Wx10H(mm)
Voltage	DC 12Vor DC 24V	DC 12Vor DC 24V
Current	12V/400mA±10%; 24V/200mA±10%	12V/400mA±10%; 24V/200mA±10%
Holding force	180kg(350Lbs)	180kg(350Lbs)
Signal output	NO	Lock signal(NO/NC/COM)
Suitable for	Wooden door , Metal door , Fireproof door	Wooden door , Metal door , Fireproof door
Cover finish	Stainless Steel	Stainless Steel
IP rate	IP-65	IP-65
Operating temp	-30~+66℃(22-151F)	-30~+66℃(22-151F)
Weight	1.2kg	1.2kg

## Dimension(unit:mm)

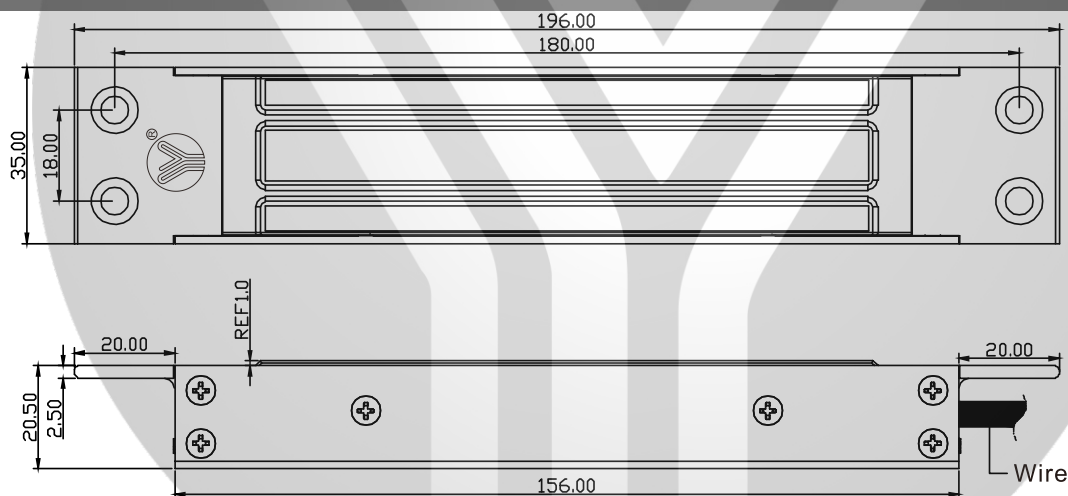

## Circuit board diagram

### Magnetic Lock

DC 12V Input

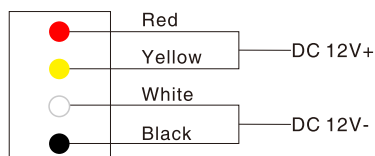

DC 24V Input

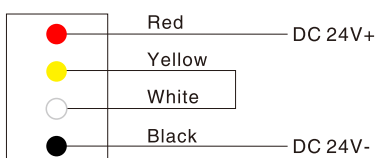

### Magnetic Lock with Signal Output

DC 12V Input

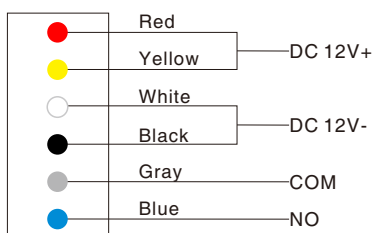

DC 24V Input

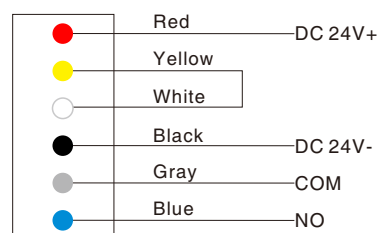



## Installation

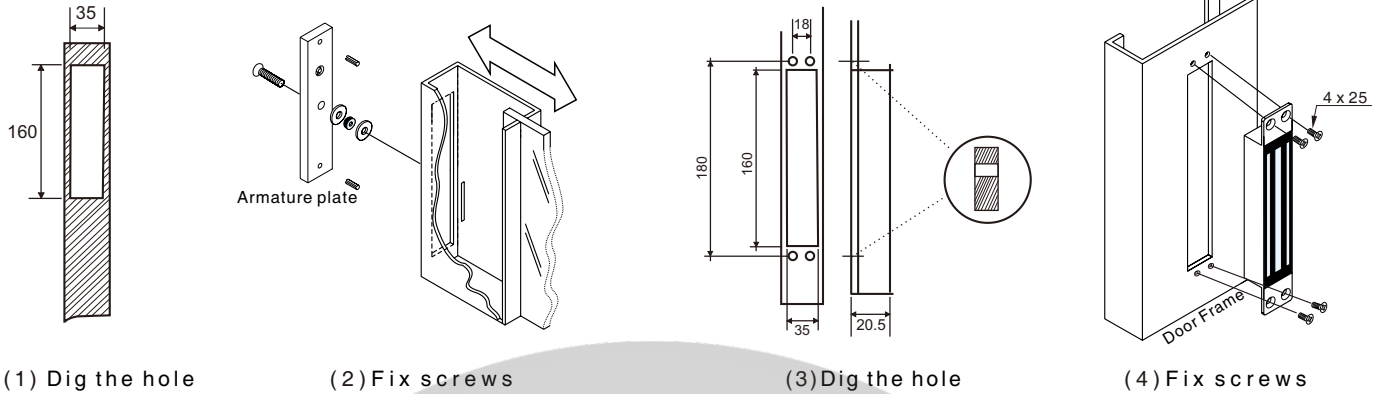

### NOTES:

Please read specification before installing magnetic lock

A. Handle the equipment carefully. The holding force can be reduced by damaging the lock body or armature plate.

B. The magnetic lock should be fixed tightly on the door frame and the armature plate on the door leaf. Kit provided allows the armature plate to pivot its center, thus compensating misalignment caused by other factors.

C. Template can only be used with the door in normally closed circumstance.

D. Please fix screws of magnetic lock firmly.

E. Detect signal of door state: the limit of reed switch and dry contact is 0.5A/30VDC. Don't overload.

## Wire Connection

