



YLI ELECTRONIC



Mortise Mount Magnetic Lock

Specification

Model	YM-350M-S-UL
Dimension	250Lx47Wx27H(mm)
Armature plate	190Lx45Wx13.2H(mm)
Voltage	12VDC
Input	12V/500mA
Holding force	500Lbs
Signal output	Lock signal(NO/NC/COM)
Suitable for	Wooden door , Metal door , Fireproof door
Cover finish	Stainless Steel
IP rate	IP-65
Weight	2.7kg
a) Static strength rating of 500 pounds-force (2224 N). b) Dynamic strength rating of 33 foot-pounds-force (45 J). c) Endurance rating of 250,000 cycles.	
Usage Environment:0~95%	
Ambient Temperature Range: -20℃~+55℃(-4~131°F)	
Destructive attack level I; Line security level I; Endurance level IV; standby power level I	

Dimension(unit:mm)

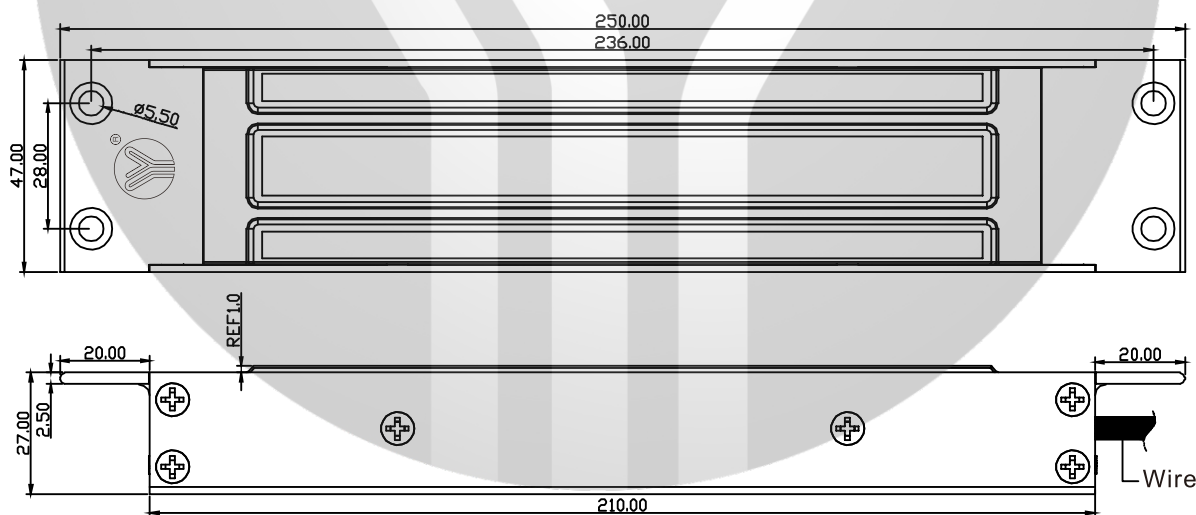

Circuit board diagram

The lead shall not be spliced to a conductor larger than 18 AWG

12V DC Input

Red	12V DC “ + ”
Orange	
Blue	12V DC “ - ”
Black	
White	COM
Green	NO

Installation

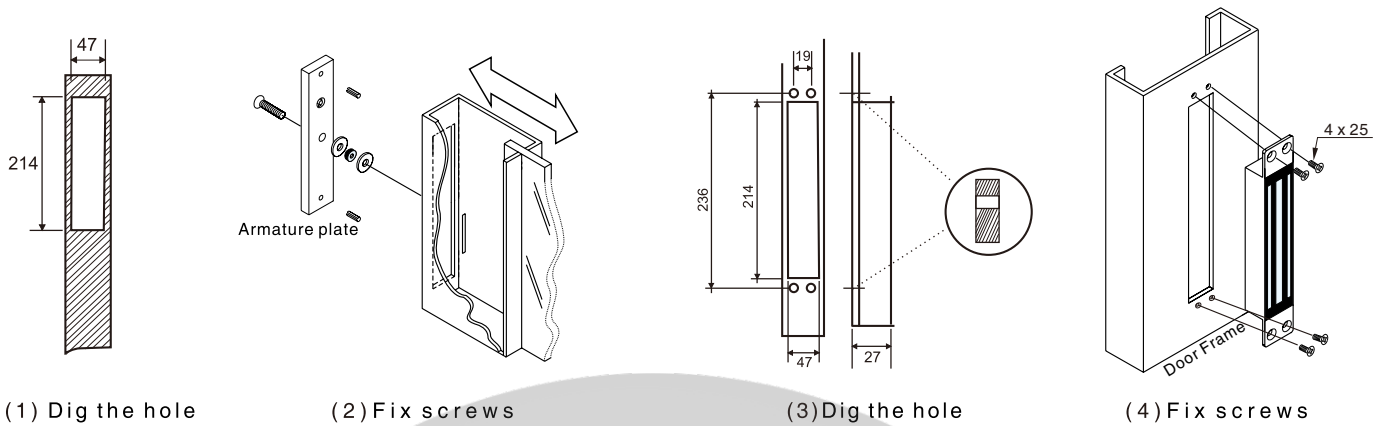

NOTES:

Please read specification before installing magnetic lock

A. Handle the equipment carefully. The holding force can be reduced by damaging the lock body or armature plate.

B. The magnetic lock should be fixed tightly on the door frame and the armature plate on the door leaf. Kit provided allows the armature plate to pivot its center, thus compensating misalignment caused by other factors.

C. Template can only be used with the door in normally closed circumstance.

D. Please fix screws of magnetic lock firmly.

E. Detect signal of door state: the limit of reed switch and dry contact is 0.5A/30VDC. Don't overload.

Wire Connection

Except for Electromagnetic lock, other products (ACCESS CONTROL, POWER SUPPLY) are not provided. Wiring is for reference, please refer to the related product wiring instruction.

