



YLI ELECTRONIC

Shear Lock

Model: YM-2400SL



SPECIFICATION

Power supply	DC12V(Need Order DC24V)
Operation Current	12V/850mA;24V/450mA
Holding Current	12V/400mA;24V/280mA
Delay Time	0/5/10/15sec.
Door status sensor	NO/COM(0.1A@30VDC)
Lock status sensor	NO/NC/COM(0.1A@30VDC)
Holding Force	2200Lbs(1000kg)
Magnetic distance(max.)	3mm
LED	Red shows locked; Green shows unlocked
Lock Size	182L X 30W X 25D(mm)
Armature Plate	182L X 30W X 23.6D(mm)
Weight	1.2kg

Model Color	9 PIN Connection		
Red	DC 12V	Black	GND
Purple	Purple wire of the light	Orange	Orange wire of the light
Green	Door Positions Sensor NO	※	Dangling
Brown	Lock Positions Sensor NC	Blue	Lock Status Sensor NO
Gray	Lock Positions Sensor COM	White	Door Status Sensor COM
Delay Time		0S	5S
		10S	15S

DIMENSION

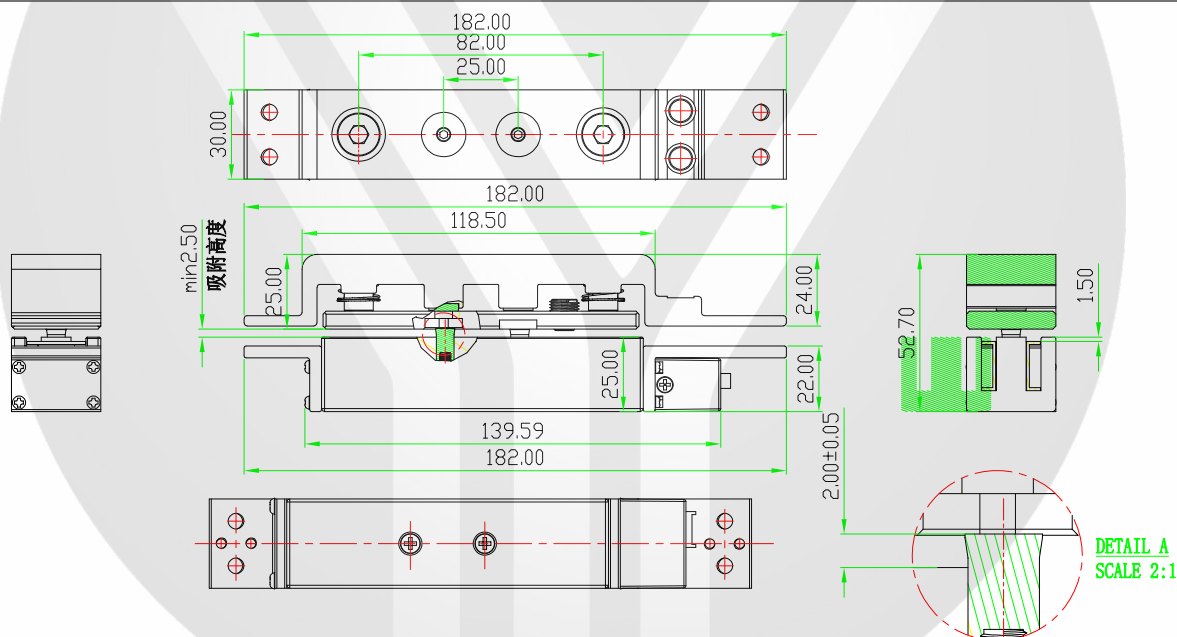

WIRING DIAGRAM

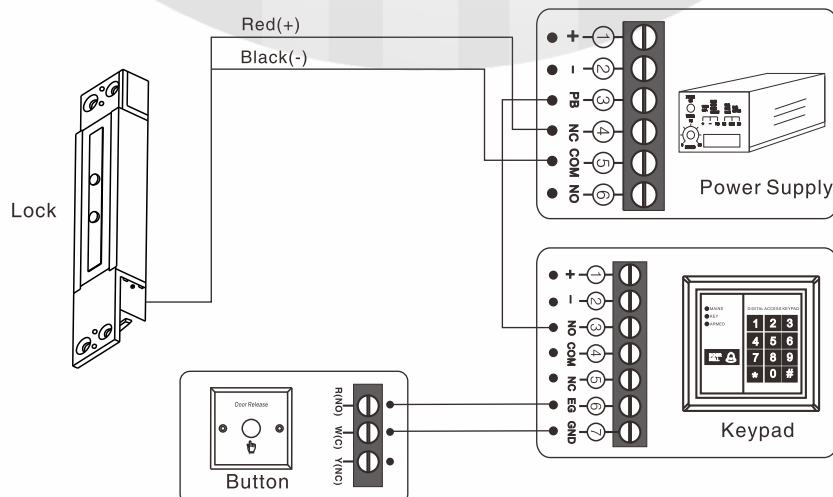

THE COMMENTARY OF HOLES

A:The Solid Door

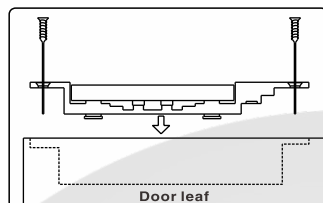
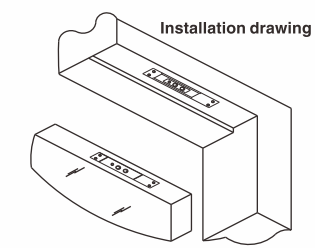
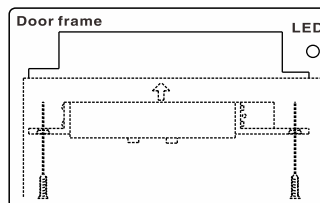
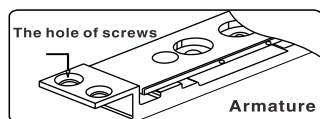
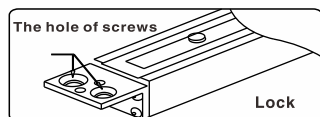

B:The Hollow Door

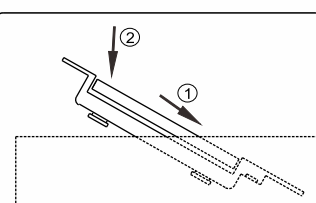
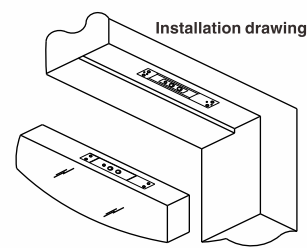
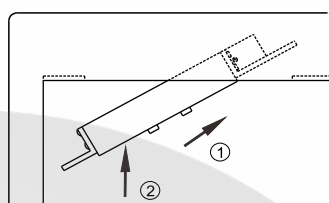
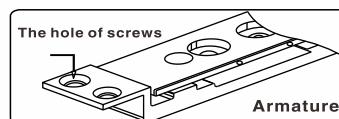
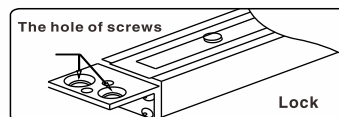

C:Use The Extended Plate

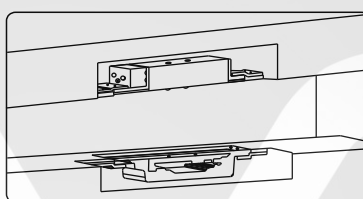
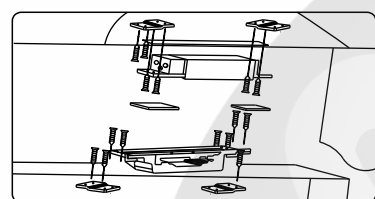

THE COMMENTARY OF INSTALLATION

Step1:Confirm the position of installation
It can be installed upon the door or the side of the door

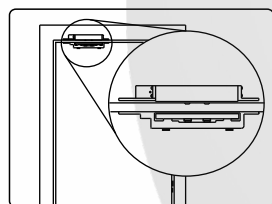

Step3:Drill the hole

Drill the hole according to the sticker, and drill the hole for the LED on the door frame

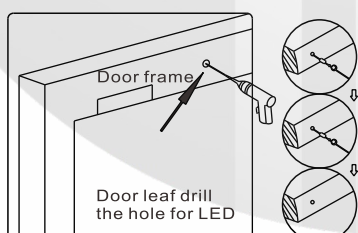
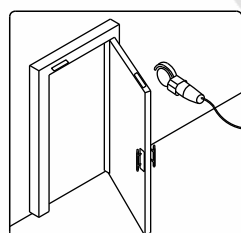

Step2:Paste the sticker

Note:Adjust the sticker to assure the proper alignment

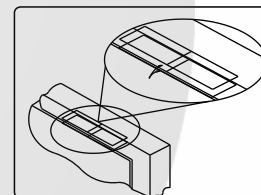
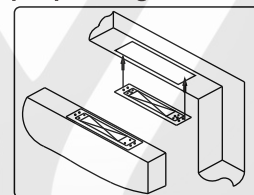

Step4:Wiring

Install the led on the door frame, and connect the 9pin

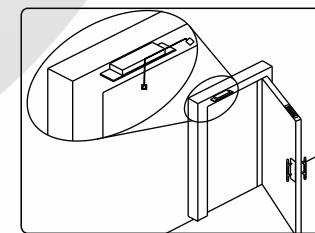
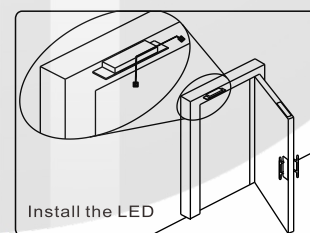

Step5:Fix the magnetic lock and armature

Connect all the wire to the shear lock body, then adjust the delay time, then fix the magnetic lock and armature

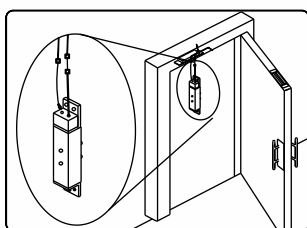

Step6:Connect the electricity and adjust

Check the operation is correct or not when connecting electricity, please adjust a little the armature when they can't adsorb

